

Interface wire color code (You can find it at the back of the reader) :

Interface	Power		RS232 (DB 9)			RS485			Trigger		Wiegand		
Wire Color	Red Thick	Black Thick	Blue	Grey	Black	White	Light Grey	Light Brown	Orange	Light Brown	Purple	Light Blue	Light Brown
Definition	+12V	GND	RX	TX	GND	485+	485-	GND	Trigger	GND	DATA 0	DATA 1	GND

NOTE 1 :

1. The Red and Black for trigger wire is not power supply, do not connect them to DC or AC Power!
2. Do not connect interface signal wire to Power Supply wire!

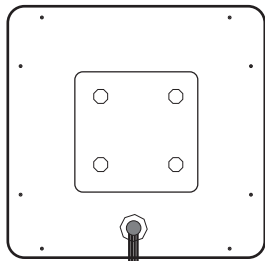

Back

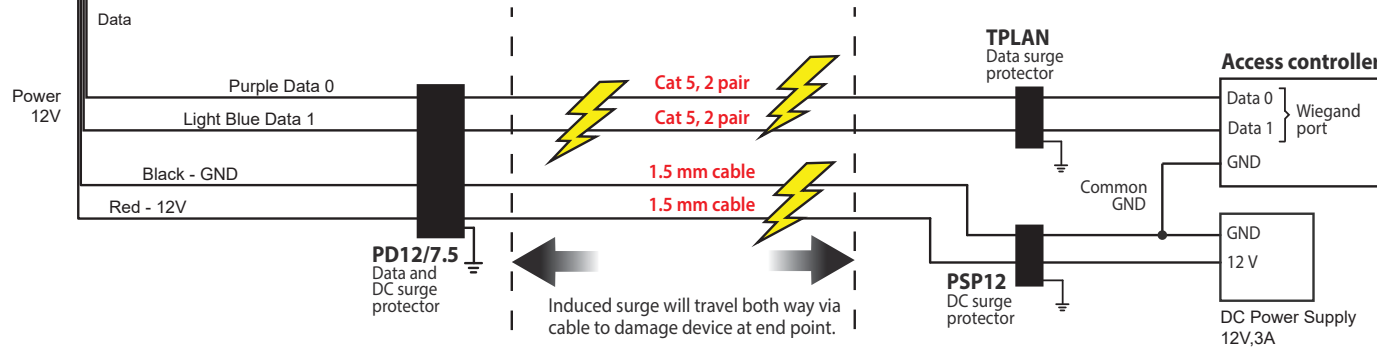

OUTSIDE NEAR BARRIER GATE
(Safely protected by surge protector at end point. All surge protector MUST be connect to EARTH.)

CABLE TRAVELING INSIDE PIPING
(Subject to lightning surge induction)

INSIDE GUARD HOUSE
(Safely protected by surge protector at end point. All surge protector MUST be connect to EARTH.)

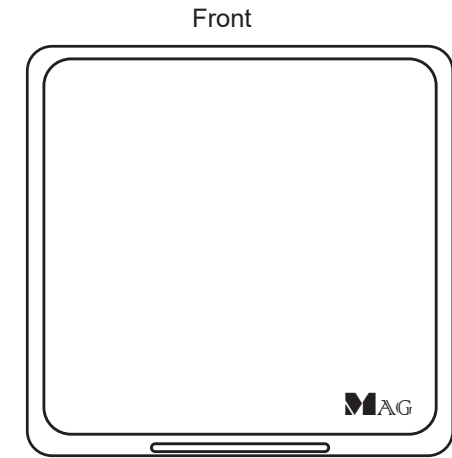

Back Bottom

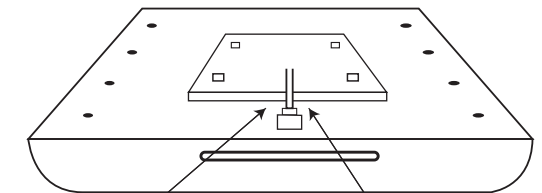

Power Supply (2 pins)
(To be supplied with 12V DC 3A)

Interface wire for controller
(8 pins)
1. Wiegand 26/34 bit
2. RS485
3. Trigger

1 . Installation Guide



2 . Correct way to hold RFID card

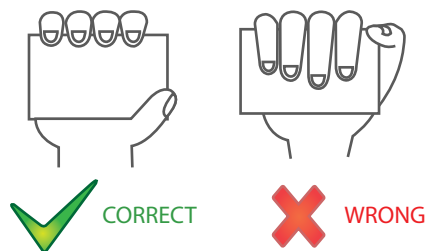

3 . Distance between windscreen and card



Best distance between car windscreen and card minimum 10mm clearance. Card should not attach directly to the windscreen surface.

4 . Installation Tips

1. Reading range may become short if used on premium solar film with heavy metal element such as Vkoool or 3M. Reading range might also be affected by interference from surrounding environment.
2. Wiegand data wiring length shall be less than 5 meter.
3. Please use 1.5 mm cable for 12V DC power. DC voltage will decrease if cable is too long. Reader will beep if the voltage supplied is less than 9V.
4. By default, reader will only read the same card after 5 sec. Please test continuous reading with at least 2 different cards.

5 . Surge protection

- a) AR300U installed outdoor is subject to damaged by lightning surge. It is compulsory to install data and power surge protector as shown in wiring diagram.
- b) Good Earth connection onto the metal pole and all metal housing will give extra protection against damage by lightning surge.