



Ensuring Your  
Peace of Mind.

## QUICK GUIDE

29 May 2021, V2.1

# FR300 Face Recognition Reader

WWW.MAG.COM.MY



### Technical Specification

| Description             | Parameter   |
|-------------------------|---|
| Access Mode             | Dynamic Face Recognition, PIN<br>Face Recognition + PIN                               |
| Validation Display      | Name & Number   |
| Facial Scanning Range   | Purely Dynamic Face Recognition: 0.5-3m<br>Infrared Live movement detection: 0.5-1.5m |
| Display Screen          | 5 inch smart touch screen   |
| Operating System        | LINUX   |
| Relay Output            | Lock Relay Output   Alarm Relay Output  |
| Relay Input             | Door sensor   |
| Push Button Input       | Yes   |
| Communication Interface | RS485, RS232, TCP/IP, WIFI  |
| External Wiegand Port   | Yes, WG26/34 Output/Input   |
| Power Supply            | DC 12V, 2A  |

### Dimension

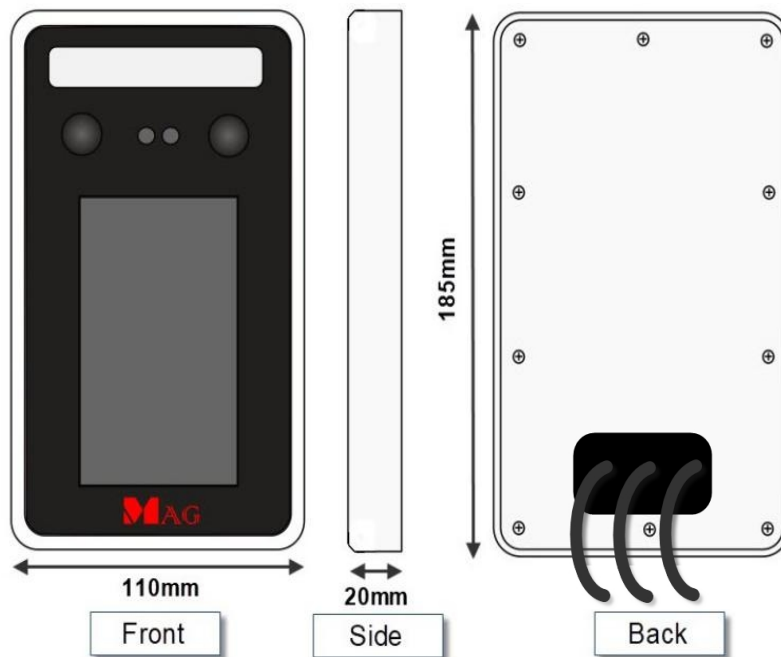

## Pedestrian Gate Bracket Mount

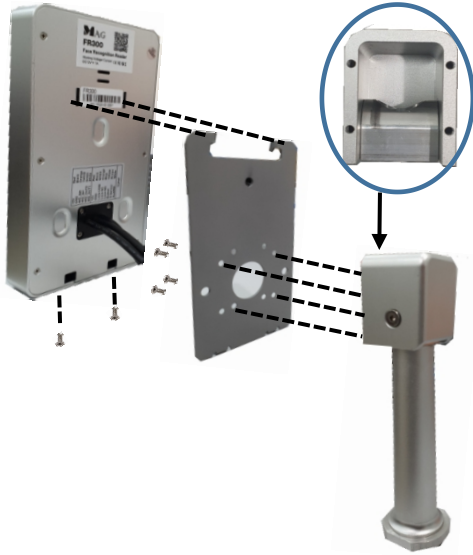

## Wall Mount

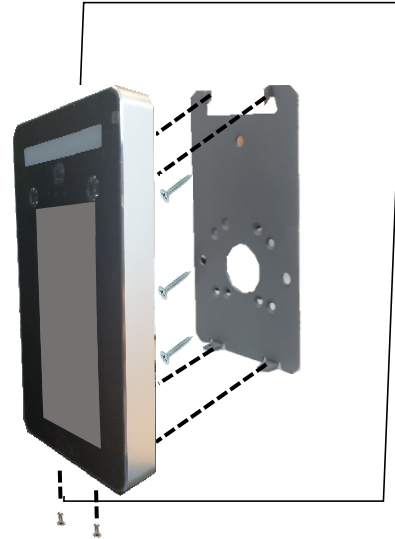

## Wiring diagram and connection

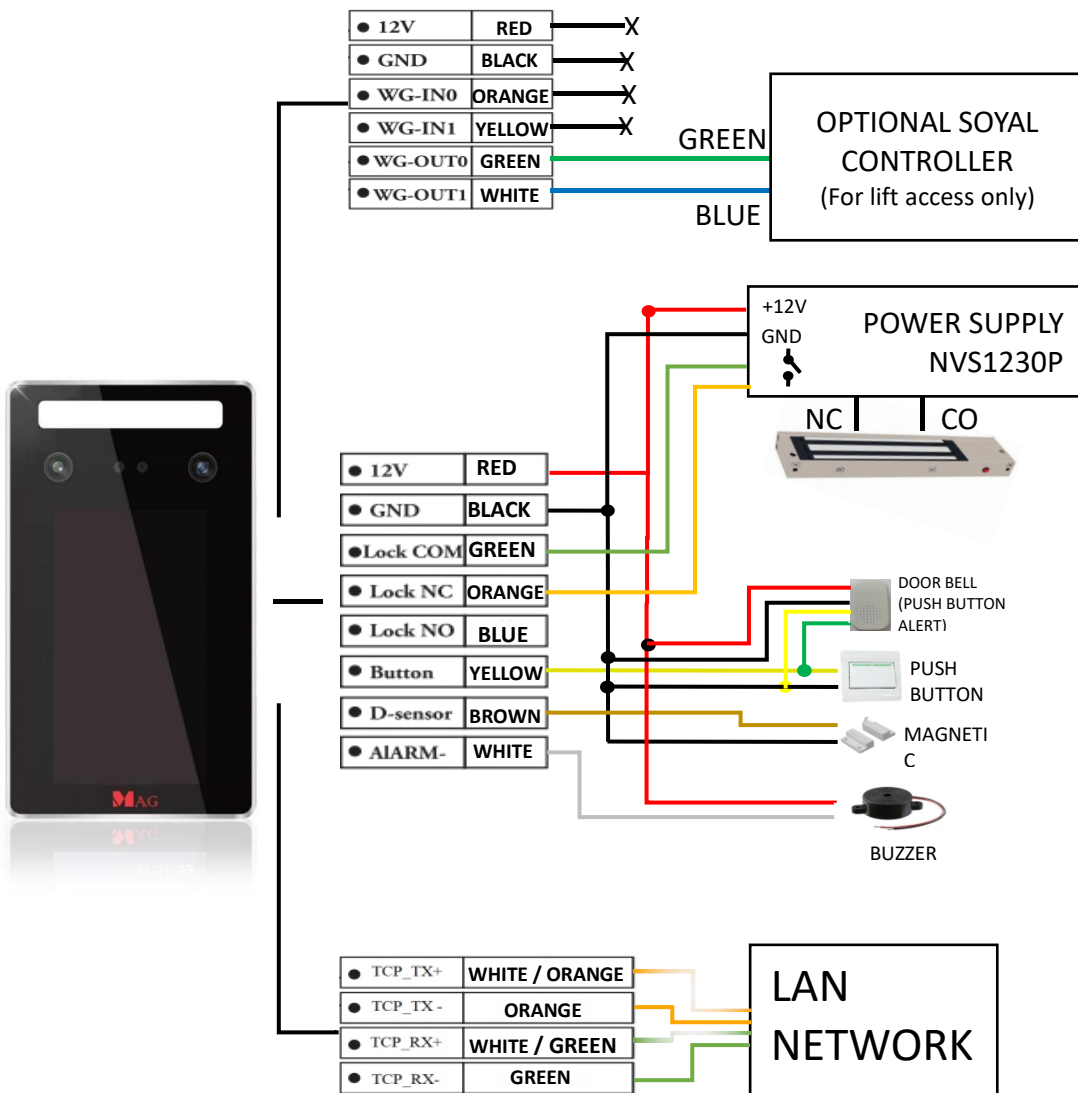

# Functional Setting

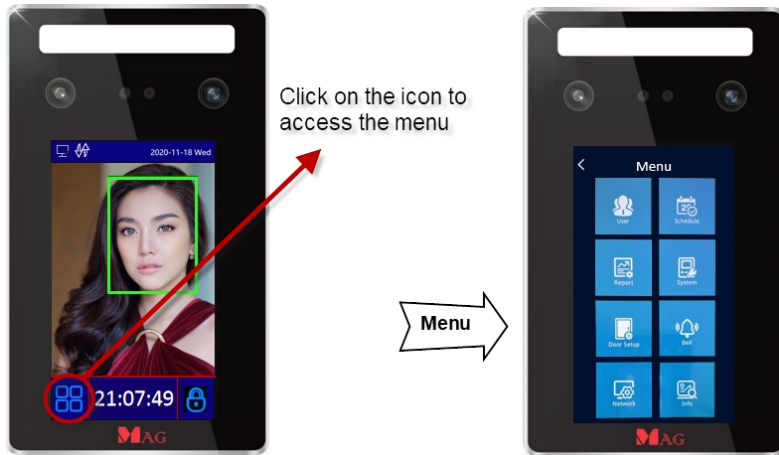

## 1) Enroll User

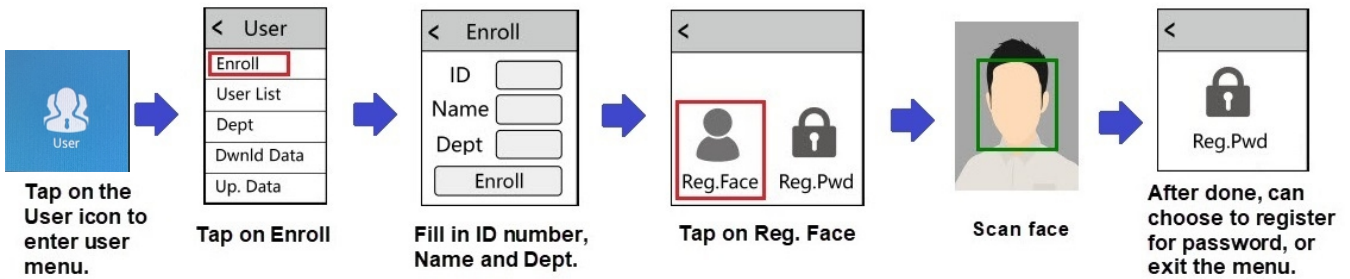

## 2) Check & Edit User List (Selection of Admin)

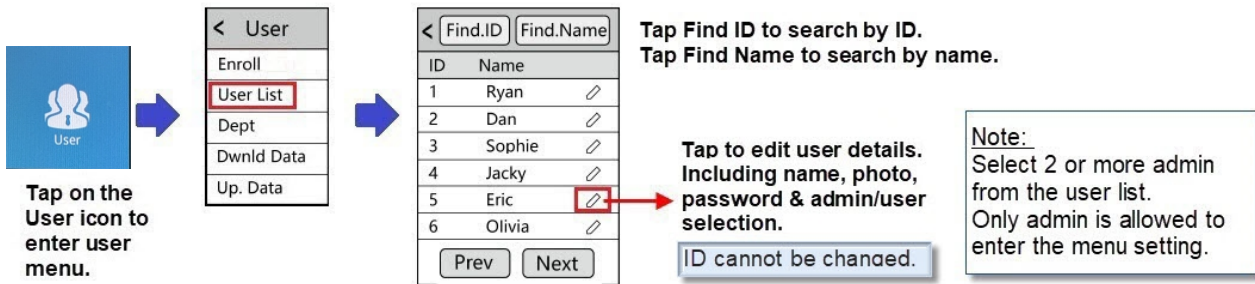

## 3) Door Setting (Door Open Time)

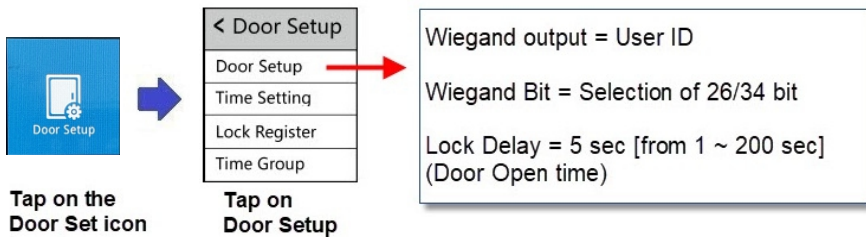

## 4) System Editing

