

Package Content:

No.	Description	Qty
1	MAG MW40 / CR3 Controller Board	1 nos
2	Transformer 3 amp (9-0-9)	1 nos
3	12v, 7Ah Backup Battery	1 nos
4	Weatherproof PVC Box	1 nos
5	Stainless Steel Arm (DC Motor)	1 pair
6	Rear Bracket	1 pair
7	Manual Release Key	1 pair
8	Remote Control Receiver	1 nos
9	Remote Control Transmitter	3 nos
10	Wall Mount Metal Plate	1 pair
11	Front Connection Bracket	1 pair
12	Front Metal Plate	1 pair
13	Stopper	1 nos
14	Bolt & Nuts	1 pack

Technical Specification:

Description	Parameter
Driving Method	Electro – mechanical screw driver piston type
Operating voltage	DC 18 V for first high speed DC 9 V for second low speed
Motor Output	15 watt per arm
Motor Amp.	2.1
Piston Displace	32 cm
Piston Speed	2.9 cm/sec

Description	Parameter
Back-up battery	12 volt. 7Ah rechargeable
Safety Clutch	Electric current sensing using H-Amp Auto Reverse
Electric Controller	Micro-processor based
Temperature	0 to 80°C
Gear Box	Three stages planetary reducer
Manual Operation	Special released key during power failure
Max. Weight of gate	250 kg per wing with force adjustable

Installation Guide:

Dimension structure for folding gate

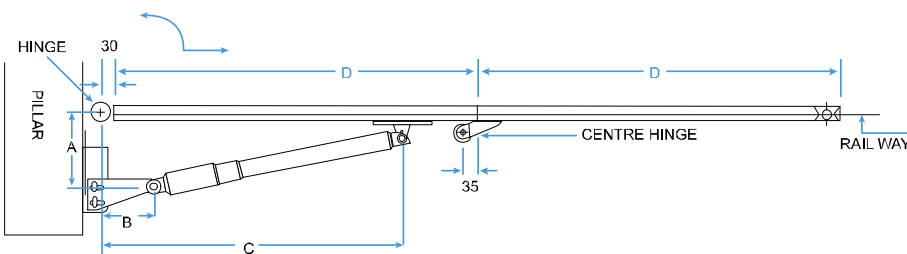

A	165mm ~ 180mm
B	128mm ~ 140mm
C	816mm ~ 837mm
D	Min.1000mm

Manual Release Key:

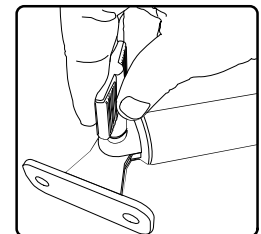

Dimension structure for swing gate

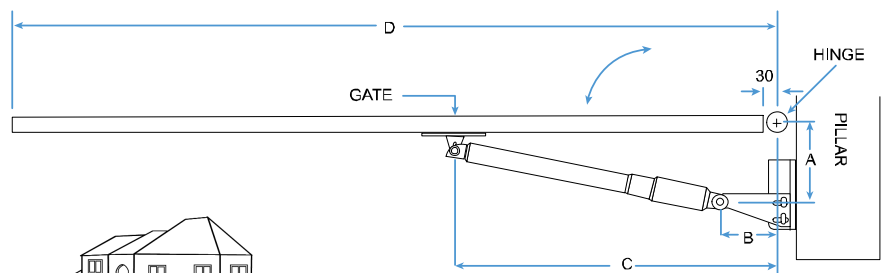

Typical Installation and Wiring Diagram:

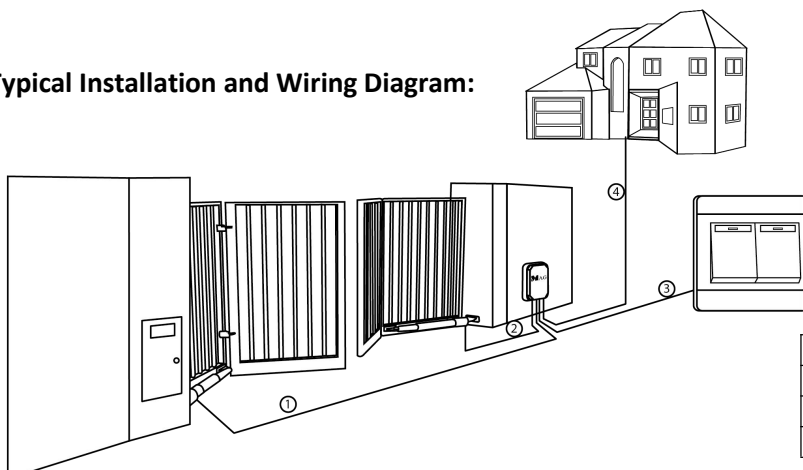

1	Stainless steel arm 1 – 2 core. 1.5mm diameter
2	Stainless steel arm 2 – 2 core. 1.5mm diameter
3	Push Button – 3 core. 1.5mm diameter
4	AC230V power supply – 3 core. 2.5mm diameter

Control Panel:

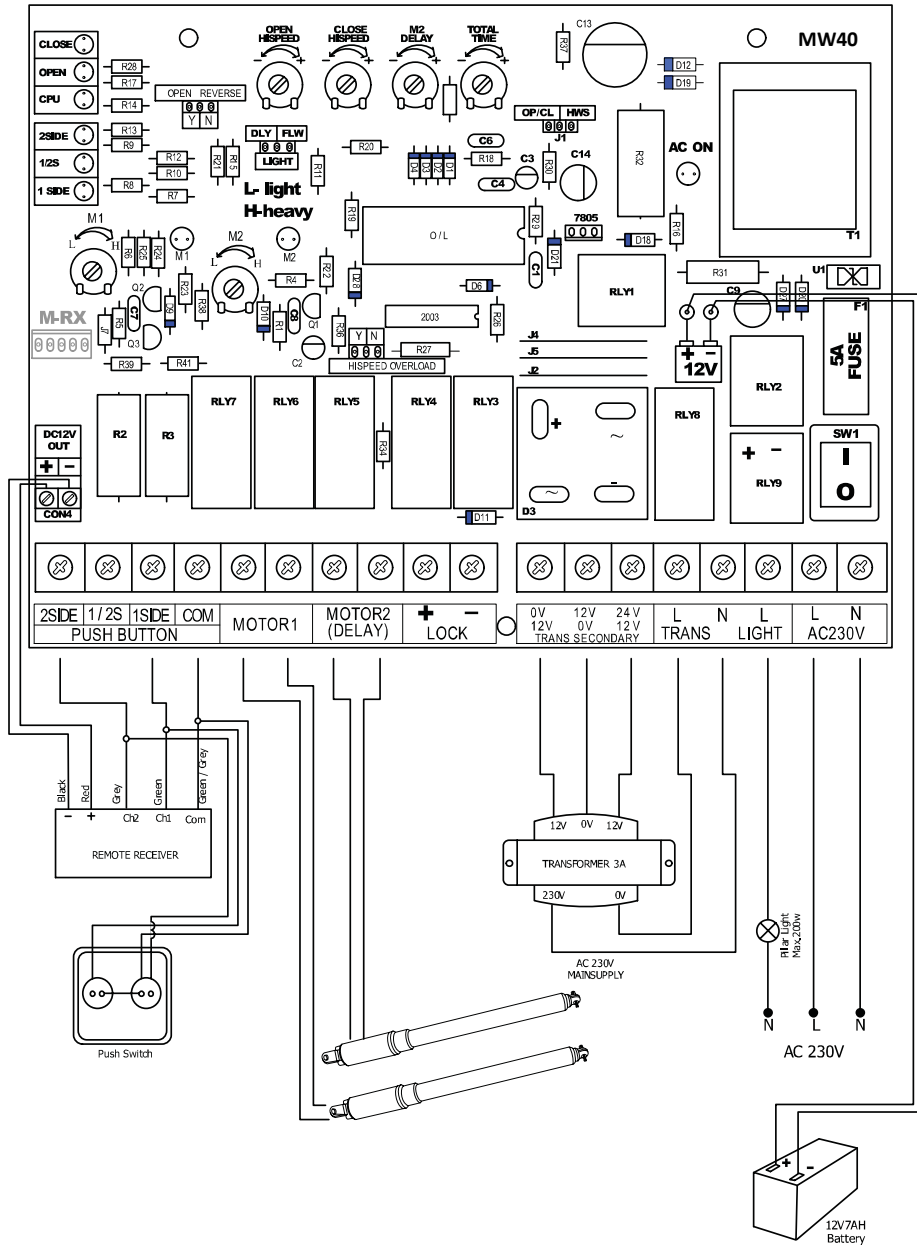

Preset	
Open Hi-speed	Adjust from 0~20 sec for opening at hi-speed
Close Hi-speed	Adjust from 0~20 sec for closing at hi-speed
M2 Delay	Adjust from 0~6 sec for closing gate with lock
Total Time	Adjust from 5~30 sec total travelling time
M1	Adjust from 1.5~4amp for motor 1 sensitivity of hi-amp cut
M2	Adjust from 1.5~4amp for motor 2 sensitivity of hi-amp cut
LED	
AC ON	When AC power and Red LED lit
Close	Turn on power Red close LED lit or when closing
Open	When opening Green LED lit until close button pressed
CPU	Turn on power Red LED 1 sec continue flash
2 Side	When 2 side push button pressed (LED blink once)
½ S	When ½S push button pressed & hold for 3 sec (LED blink once)
1 Side	When 1 side push button pressed (LED blink once)
Jumper	
Open reverse	“Y” for lock with 0.5 sec reverse when opening.
OP/CL HWS	Press against button gate will reverse close/open at half way. Press against button gate will stop at half way.
Hi speed overload	“Y” when opening hi-amp cut gate will stop, when closing hi-amp cut gate will reverse.
Light – DLY	Pillar light remain on for 30 sec after gate close.
– FLW	Pillar light follow motor cut off time.

Wiring Connection		
Push Button	2 side	Press for both gate open/close
	½ s	Press & hold for 3 sec. Lock side gate open. (for 2 wire only)
	1 side	Press for lock side gate open.
Motor		
Motor 1	Connect to arm motor	
Motor 2 (Delay)	Connect to arm motor with lock	
Lock	Optional DC12V lock require	
Trans Secondary	Connect 3amp main transformer secondary terminal	
Trans	Connect 3amp main transformer primary terminal	
Light	Connect to pillar light LIVE wire terminal	
AC230V	Connect to AV230V main power supply	